

# Multi-purpose Meter Door



Galvanized



Pre-lacquered BL-Andreu



Pre-lacquered GR-Andreu



Powder coated RAL



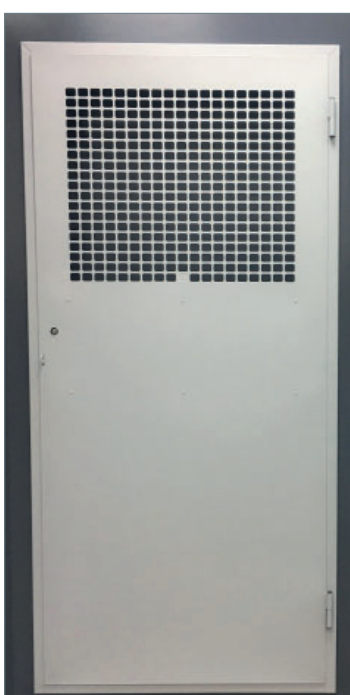

Multi-purpose Meter Door 2/4  
Ed.01/09/23

### SECTION A-A'

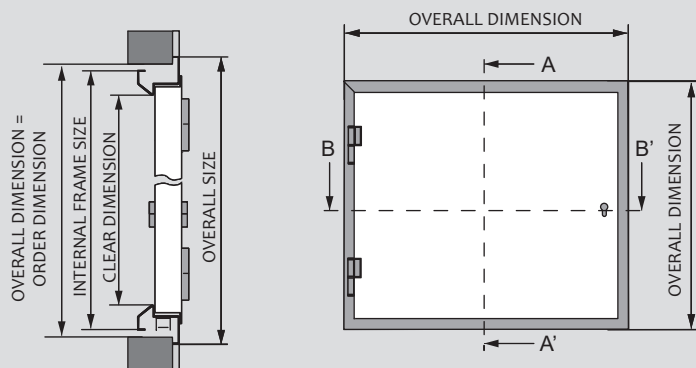

### SECTION B-B'

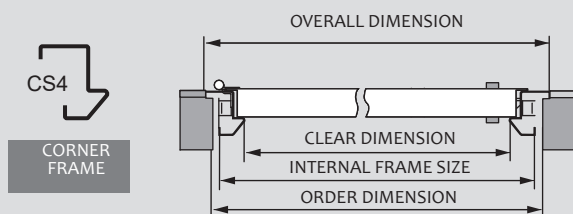

Model	Order Size		Clear Opening		Internal Frame		Overall (Ext. Frame)	
	Width	Height	Width	Height	Width	Height	Width	Height
Without ventilation	700	700	610	610	680	680	720	720
With ventilation	700	700	610	610	680	680	720	720

Standard measurements in millimeters. Possibility of other measurements on request.

# Ensamblada Meter Door

The Ensamblada Meter door has the same features as the Ensamblada model door with the following difference:

- Quantity of hinges depending on the door height.
- Closed frame on 4 sides.

### LOCKING AND OPERATING SYSTEM

- 30 X 30 cylinder.
- Keyhole on both sides.
- For customised dimensions: escutcheon with keyhole, with handle or dead knob.

# Water Meter Door

### STRUCTURE

1.2mm galvanised steel sheet, punched, bent and riveted.

It has no hinges and is reversible.

The door is available with and without louvers options.

### FRAME

Frame made of 1.2mm galvanised steel sheet. Includes four anchors for installation on site.

### LOCKING AND OPERATING SYSTEM

Metallic tongue locking screwed to the leaf (A).

Square access key (B).

Padlock lug (C).

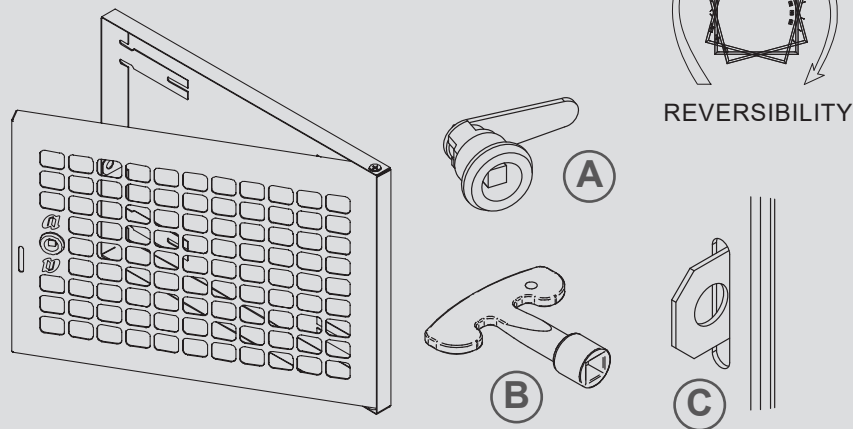

Door	Order Size		Clear Opening		Internal Frame		Overall (Ext. Frame)	
	Width	Height	Width	Height	Width	Height	Width	Height
Plain	400	300	360	260	400	300	400	300
Micro	400	300	360	260	400	300	400	300

Standard measurements in millimeters. Possibility of other measurements on request.

# Electro Meter Door

Another type of Ensamblada doors are Electro Meter Door.

There are 3 models depending on the ventilation: Plain (A), Louvered (B) and Micro Model (C).

## STRUCTURE

0.8mm galvanised steel sheet die-cut, folded and riveted.

Two galvanised hinges.

## FRAME

Corner CS4 frame.

## LOCKING AND OPERATING SYSTEM

Steel lock installed in the leaf edge (D).

Triangular access key (E).

Padlock lug (F).

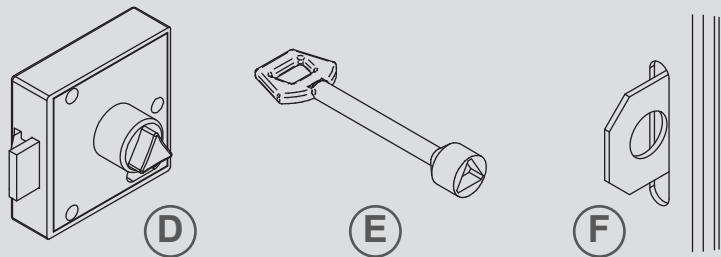
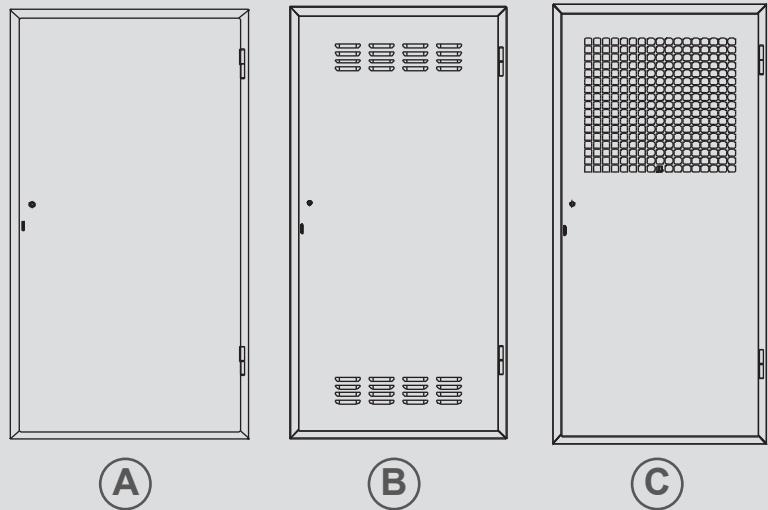

CORNER FRAME

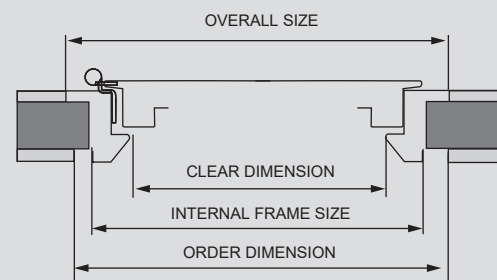

Model	Order Size		Clear Opening		Internal Frame		Overall (Ext. Frame)	
	Width	Height	Width	Height	Width	Height	Width	Height
Plain	660	560	570	470	640	540	680	580
	790	1090	700	1000	770	1070	810	1110
	790	1290	700	1200	770	1270	810	1310
	790	1490	700	1400	770	1470	810	1510
Micro	790	1490	700	1400	770	1470	810	1510
	790	1690	700	1600	770	1670	810	1710
Louvered	660	560	570	470	640	540	680	580
	790	1090	700	1000	770	1070	810	1110
	790	1290	700	1200	770	1270	810	1310
	790	1490	700	1400	770	1470	810	1510

Standard measurements in millimeters. Possibility of other measurements on request.